

PNP Transistors

■ Features

- Adoption of FBET, MBIT Processes
- High Breakdown Voltage and Large Current Capacity
- Complementary to 2SC3647

SOT-89-3L

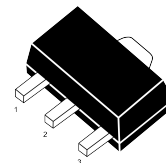

1. BASE
2. EMITTER
3. COLLECTOR



■ Absolute Maximum Ratings Ta = 25°C

Parameter	Symbol	Rating	Unit
Collector - Base Voltage	V _{CB0}	-120	V
Collector - Emitter Voltage	V _{CE0}	-100	
Emitter - Base Voltage	V _{EB0}	-6	
Collector Current - Continuous	I _C	-2	A
Collector Current - Pulsed	I _{CP}	-3	
Collector Power Dissipation	P _C	500	mW
Junction Temperature	T _J	150	°C
Storage Temperature range	T _{stg}	-55 to 150	

■ Electrical Characteristics Ta = 25°C

Parameter	Symbol	Test Conditions	Min	Typ	Max	Unit
Collector- base breakdown voltage	V _{CB0}	I _C = -100 μA, I _E =0	-120			V
Collector- emitter breakdown voltage	V _{CE0}	I _C = -1 mA, R _{BE} =∞	-100			
Emitter - base breakdown voltage	V _{EB0}	I _E = -100 μA, I _C =0	-6			
Collector-base cut-off current	I _{CB0}	V _{CB} = -100 V, I _E =0			-0.1	μA
Emitter cut-off current	I _{EB0}	V _{EB} = -4V, I _C =0			-0.1	
Collector-emitter saturation voltage	V _{CE(sat)}	I _C =-1A, I _B =- 100mA		-0.22	-0.6	V
Base - emitter saturation voltage	V _{BE(sat)}	I _C =-1A, I _B =- 100mA		-0.85	-1.2	
DC current gain	h _{FE}	V _{CE} = -5V, I _C = -100mA	100		400	
Turn-on time	t _{on}	See Test Circuit.		80		ns
Storage time	t _s			750		
Fall time	t _f			40		
Output capacitance	C _{ob}	V _{CB} = -10V, I _E = 0, f=1MHz		25		pF
Transition frequency	f _T	V _{CE} = -10V, I _E = -100mA		120		MHz

■ Classification of h_{FE}

Type	2SA1417-R	2SA1417-S	2SA1417-T
Range	100-200	140-280	200-400
Marking	ACR	ACS	ACT

Test Circuit

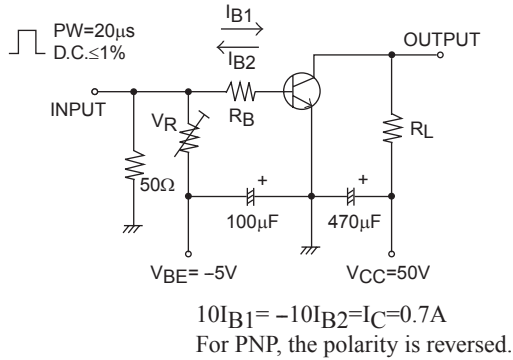

Typical Characteristics

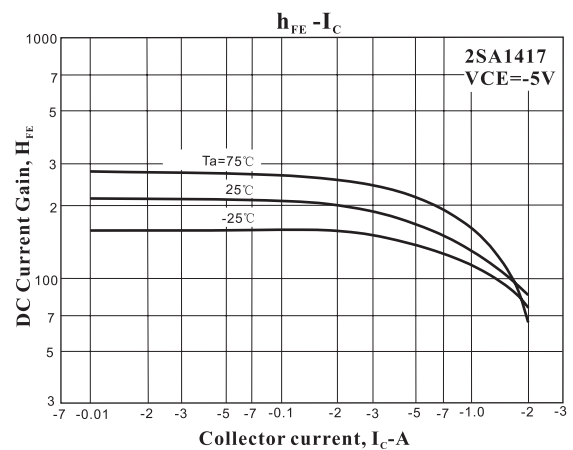
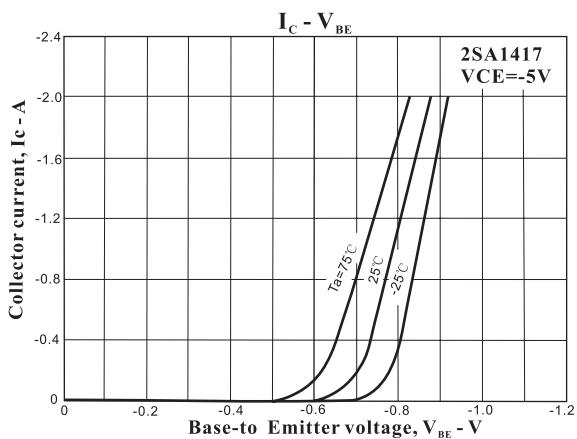
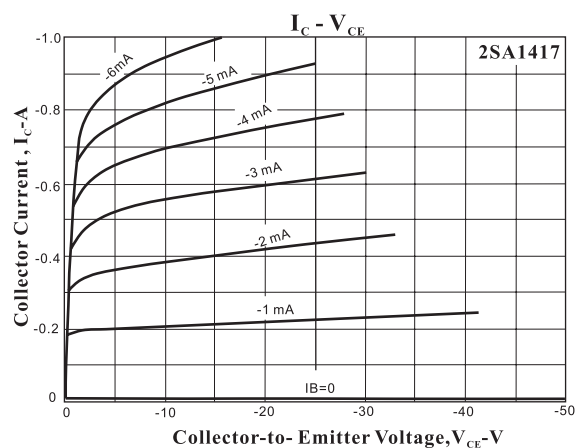
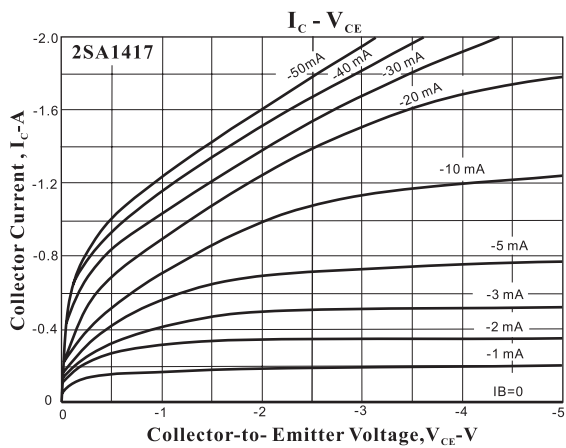

Typical Characteristics

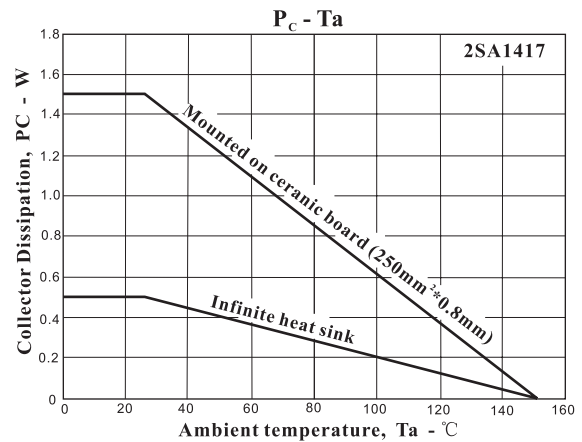
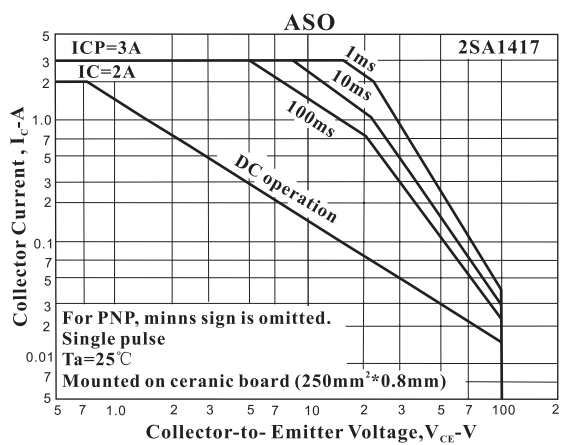
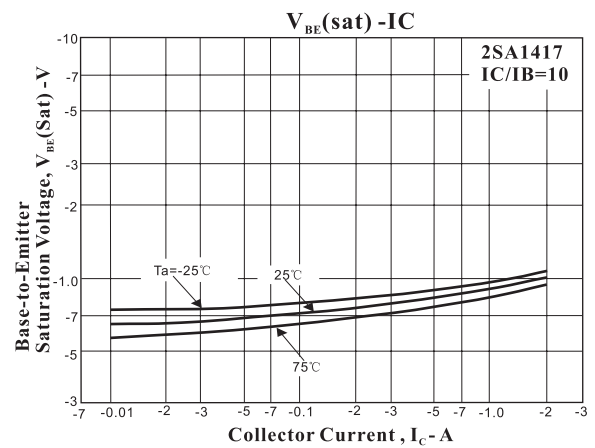
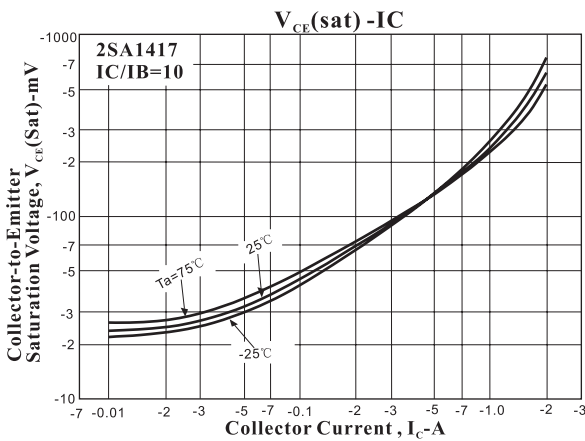
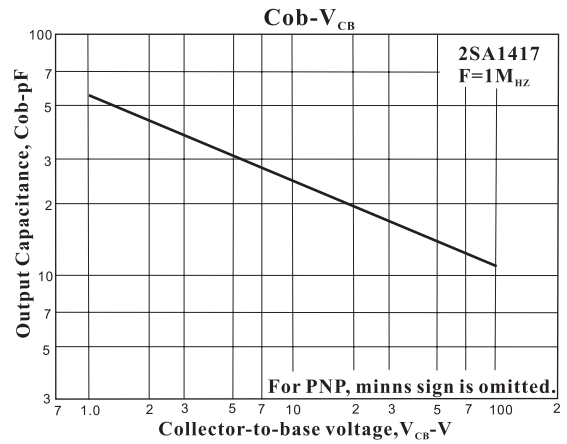
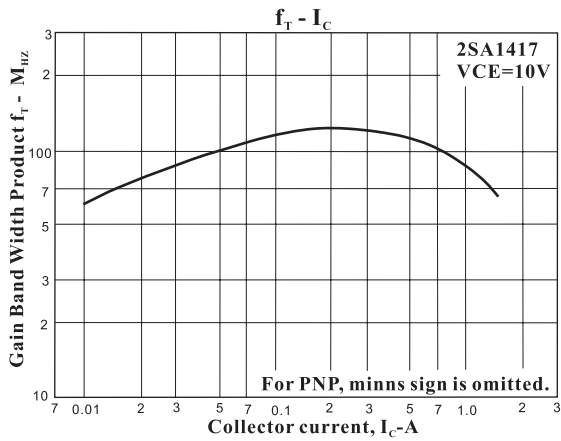

SOT-89-3L Tape and Reel

SOT-89-3L Embossed Carrier Tape

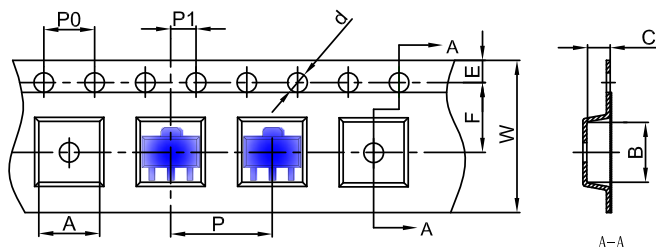

Dimensions are in millimeter										
Pkg type	A	B	C	d	E	F	P0	P	P1	W
SOT-89-3L	4.85	4.45	1.85	Ø1.50	1.75	5.50	4.00	8.00	2.00	12.00

SOT-89-3L Tape Leader and Trailer

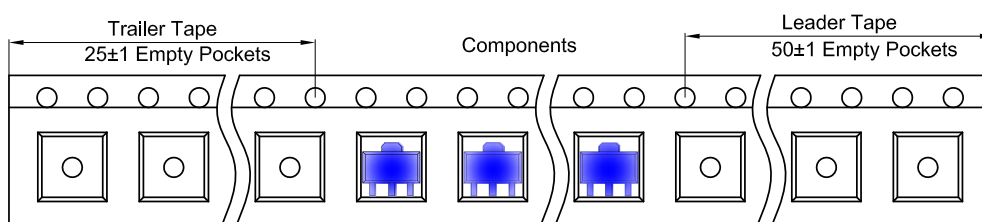

SOT-89-3L Reel

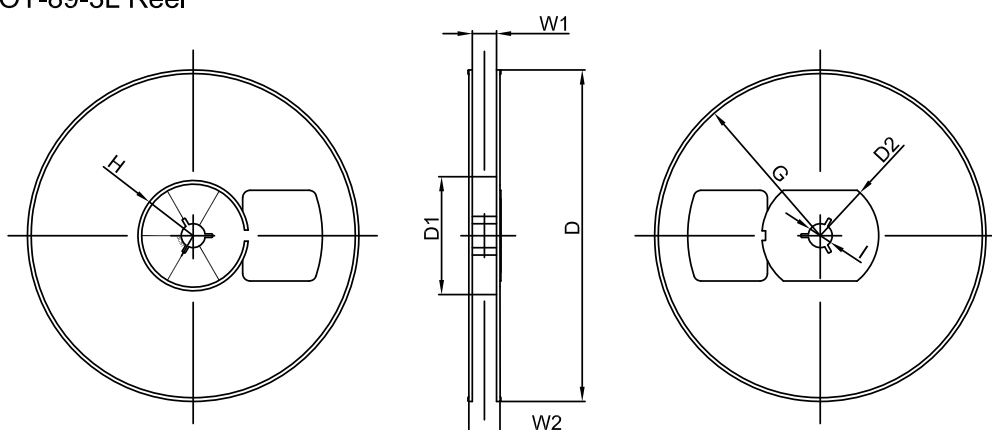

Dimensions are in millimeter								
Reel Option	D	D1	D2	G	H	I	W1	W2
7" Dia	Ø180.00	60.00	R32.00	R86.50	R30.00	Ø13.00	13.20	16.50

REEL	Reel Size	Box	Box Size(mm)	Carton	Carton Size(mm)	G.W.(kg)
1000 pcs	7 inch	10,000 pcs	203×203×195	40,000 pcs	438×438×220	

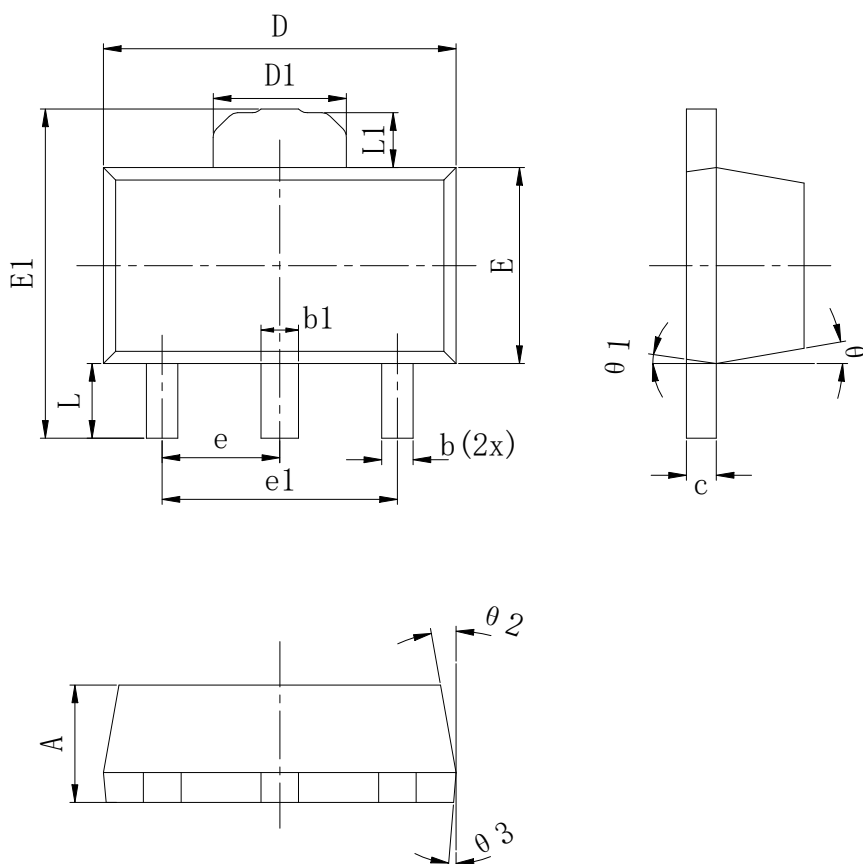

SYMBOL	MILLIMETER		
	MIN	TYP.	MAX
A	1.400	1.500	1.600
b	0.320	0.400	0.520
b1	0.400	0.480	0.580
c	0.350	0.381	0.440
D	4.400	4.500	4.600
D1	1.700REF		
E	2.400	2.500	2.600
E1	4.050	4.200	4.350
e	1.500TYP.		
e1	3.000TYP.		
L	0.800	0.950	1.200
L1	0.700REF		
θ	10° REF		
θ 1	8° REF		
θ 2	10° REF		
θ 3	5° REF		

DISCLAIMER

JHG PROVIDES TECHNICAL AND RELIABILITY DATA (INCLUDING DATASHEETS), DESIGN RESOURCES (INCLUDING REFERENCE DESIGNS), APPLICATION OR OTHER DESIGN ADVICE, SAFETY INFORMATION, AND OTHER RESOURCES "AS IS" AND WITH ALL FAULTS, AND DISCLAIMS ALL WARRANTIES, EXPRESS AND IMPLIED, INCLUDING WITHOUT LIMITATION ANY IMPLIED WARRANTIES OF MERCHANTABILITY, FITNESS FOR A PARTICULAR PURPOSE OR NON-INFRINGEMENT OF THIRD PARTY INTELLECTUAL PROPERTY RIGHTS.

These resources are intended for skilled developers designing with JHG products. You are solely responsible for

- (1) selecting the appropriate JHG products for your application;
- (2) designing, validating and testing your application;
- (3) ensuring your application meets applicable standards, and any other safety, security, or other requirements.

These resources are subject to change without notice. JHG grants you permission to use these resources only for development of an application that uses the JHG products described in the resource. Other reproduction and display of these resources are prohibited. No license is granted to any other JHG intellectual property right or to any third party intellectual property right. JHG disclaims responsibility for, and you will fully indemnify JHG and its representatives against, any claims, damages, costs, losses, and liabilities arising out of your use of these resources.